

SHEET 60

12/31/12	Tax Map Revisions	DESCRIPTION
REVISED		
SB	REV. BY	CHK.

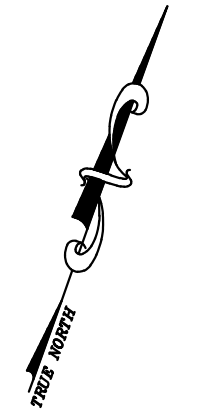

TOWNSHIP OF EDISON - MIDDLESEX COUNTY

NEW JERSEY STATE HIGHWAY ROUTE 4 PARKWAY

SHEET 51

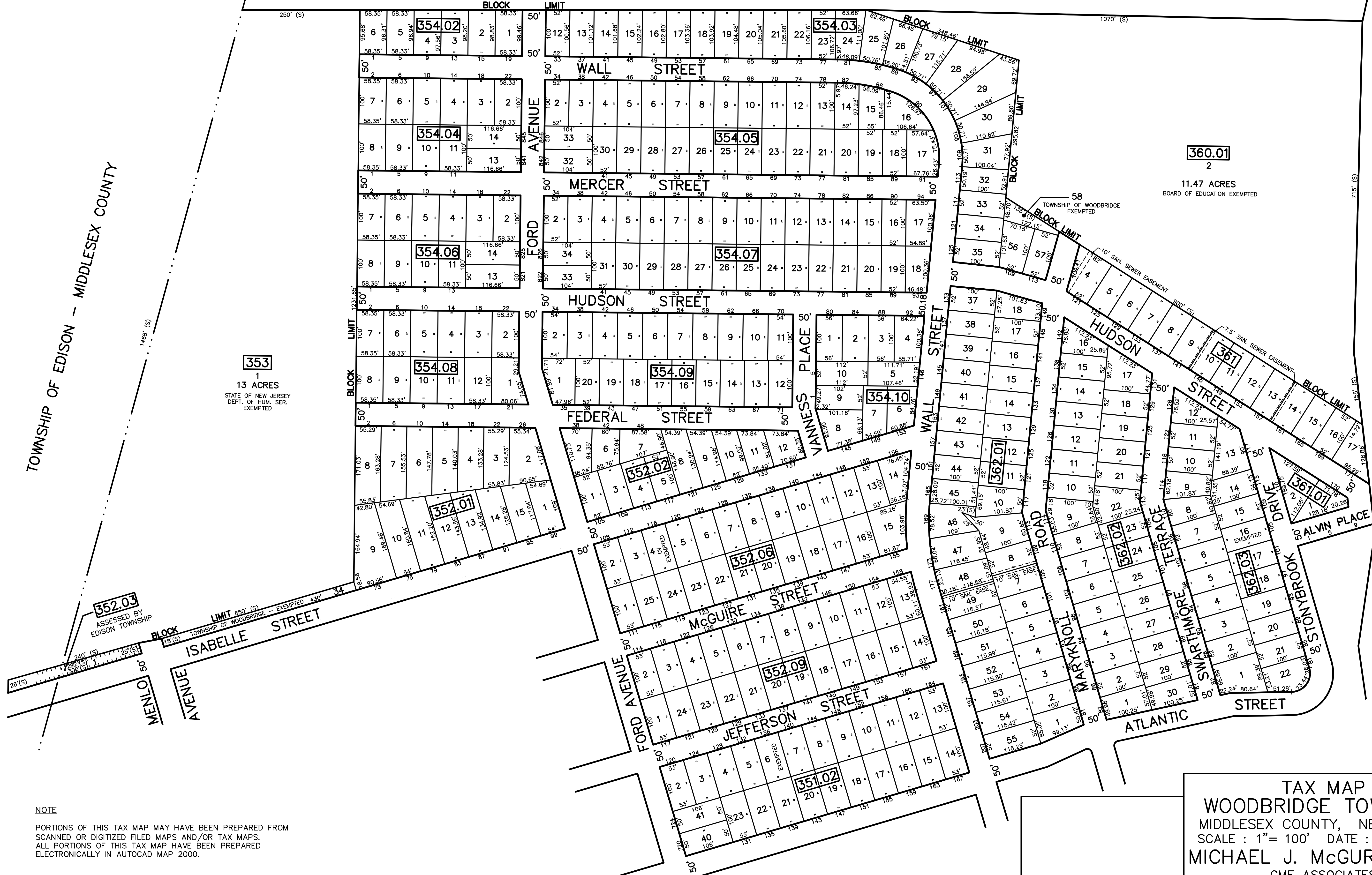

353
1
13 ACRES
STATE OF NEW JERSEY
DEPT. OF HUM. SER.
EXEMPTED

352.03
ASSESSED BY
EDISON TOWNSHIP

NOTE
PORTIONS OF THIS TAX MAP MAY HAVE BEEN PREPARED FROM
SCANNED OR DIGITIZED FILED MAPS AND/OR TAX MAPS.
ALL PORTIONS OF THIS TAX MAP HAVE BEEN PREPARED
ELECTRONICALLY IN AUTOCAD MAP 2000.

TAX MAP
WOODBIDGE TOWNSHIP
MIDDLESEX COUNTY, NEW JERSEY
SCALE : 1" = 100' DATE : JUNE 2008
MICHAEL J. McGURL, P.L.S.
CME ASSOCIATES
3141 BORDENTOWN AVENUE, PARLIN
NEW JERSEY, 08859

SHEET 48

SHEET 49